



**PISCES SA**  
BY OSSEUS

### **FUSION FOCUSED**

Patented 3D-printed diamond lattice network connects large graft window to rough endplates, promoting bony fusion onto, into, and through the device.

### **LOCKED IN**

Guided locking plate secures bone screws and anchors with audible and tactile lock confirmation.

### **MINIMALLY INVASIVE**

Bone anchor fixation allows for a direct anterior approach through a minimal midline access without angling instruments.

### **VERSATILE FIXATION**

Interchangeable bone screws and bone anchors allow for maximum intraoperative versatility.

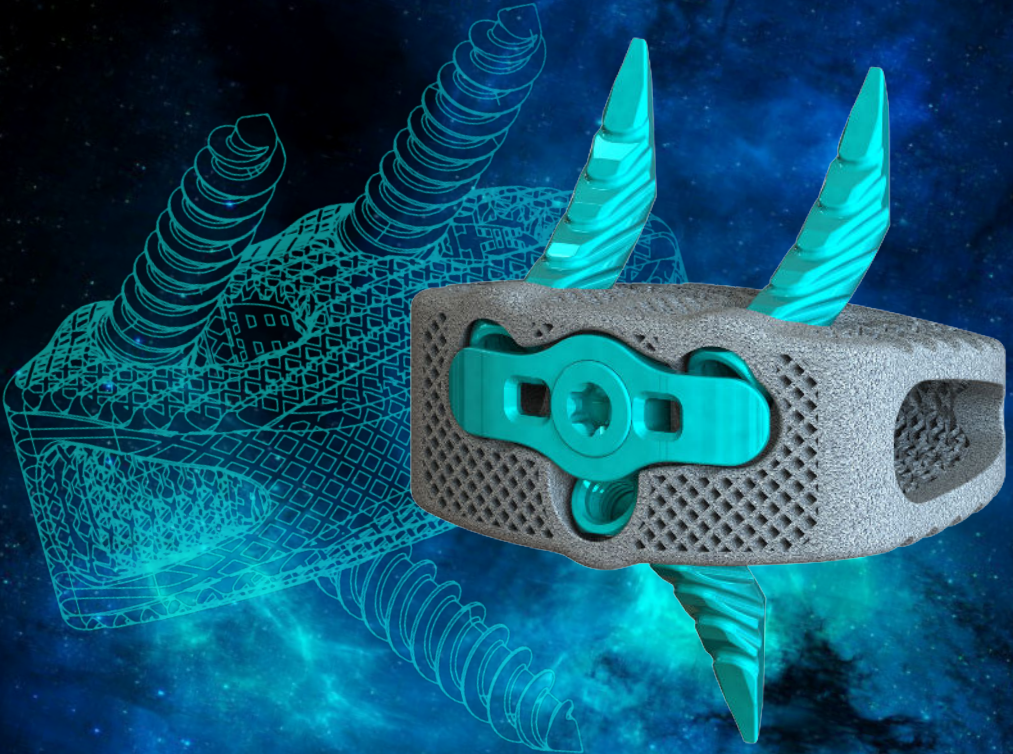

The PISCES-SA is an innovative Standalone ALIF platform integrating a highly porous 3D-printed titanium interbody with anatomical morphology designed for full osseointegration, streamlined anchor fixation technology for a minimally invasive approach, and a guided locking plate with lock confirmation. With an emphasis on fusion, fixation, and MIS approach, the PISCES-SA is the new standard for Standalone ALIF.

## TECHNICAL SPECIFICATIONS

### PISCES-SA INTERBODIES

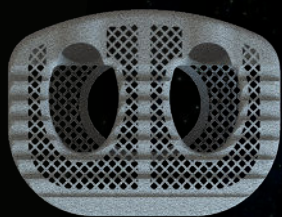

#### FOOTPRINTS:

26 x 35mm  
29 x 39mm

#### HEIGHTS:

9mm 15mm  
11mm 17mm  
13mm 19mm

#### LORDOSES:

8°  
12°  
16°  
20°

### PISCES-SA BONE SCREWS

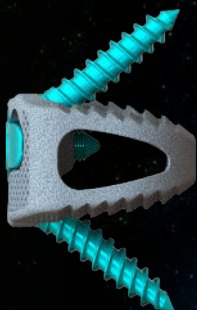

#### STYLES:

Variable  
Self - Drilling  
Self - Tapping

#### DIAMETERS:

Ø5.0mm  
Ø5.5mm

#### LENGTHS:

22.5mm  
25.0mm  
30.0mm  
35.0mm

### PISCES-SA BONE ANCHORS



#### LENGTHS:

22.5mm

#### DIAMETERS:

Ø5.0mm